

# 3mm Round Super Bright LED Lamp

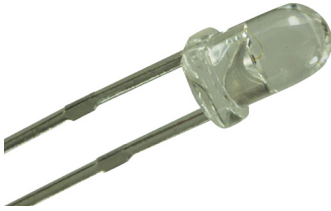

## Specifications

Dice Material	: AlInGaP
Peak Wave Length	: 660nm
Emitted Colour	: Ultra Red
Viewing Angle (deg)	: 36
Lens Colour	: Water Clear
IV(mcd)	: 3800

## Electrical / Optical Characteristics at TA = 25°C

Parameter	Symbol	Min.	Typ.	Max.	Unit	Test
Luminous Intensity	IV	3000	3800	5000	mcd	IF = 20mA
Viewing Angle	2Θ1/2	-	36	-	deg	
Peak Emission Wavelength	λp	655	660	665	nm	
Dominant Wavelength	λD	-	640	-	nm	
Spectral Line Half-Width	Δλ	-	20	-	nm	
Forward Voltage	VF	2	2.2	2.4	V	
Power Dissipation	Pd	-	-	85	mW	
Peak Forward Current (Duty1/10 @ 1kHz)	IF (Peak)	-	-	100	mA	
Recommended Operating Current	IF (Rec)	-	20	-	mA	

## Absolute Maximum Rating TA = 25°C

Reverse Voltage	5 Volt
Reverse Current	10μA (VR=5V)
Operating Temperature Range	-40°C to +85°C
Storage Temperature Range	-40°C to +100°C
Lead Soldering Temperature Range (1.6mm (1/16 inch) from body)	260°C For 5 Seconds

## Typical Electro-Optical Characteristics Curves

Ultra Red (AlGaInP) λP=660nm

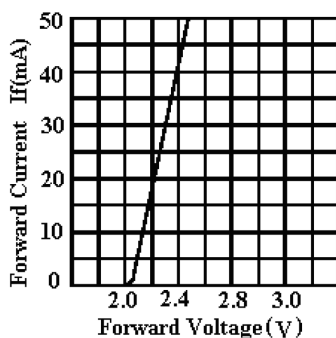

Forward current vs. Forward Voltage

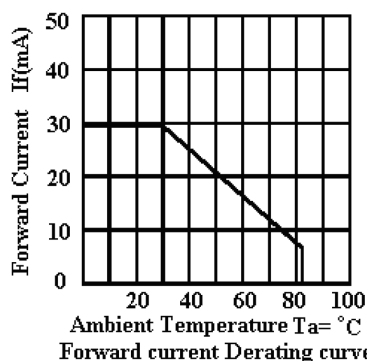

Forward current Derating curve

# 3mm Round Super Bright LED Lamp

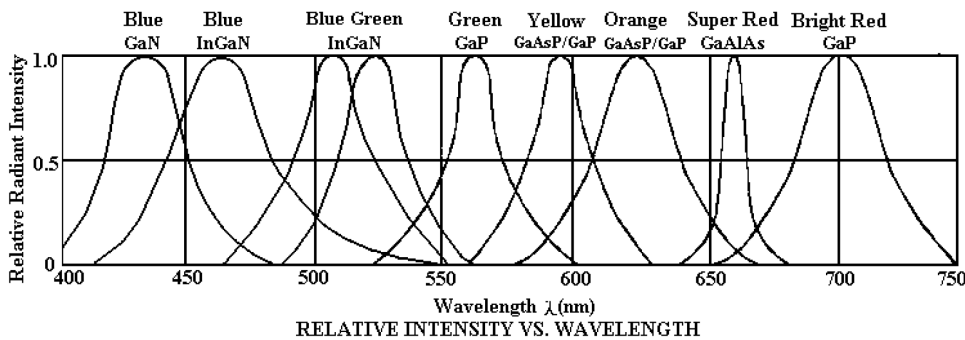
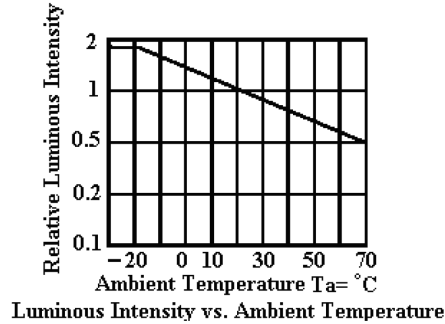
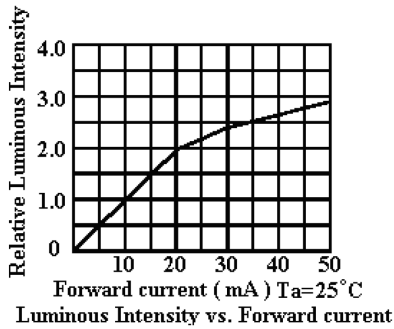

## Dimensions

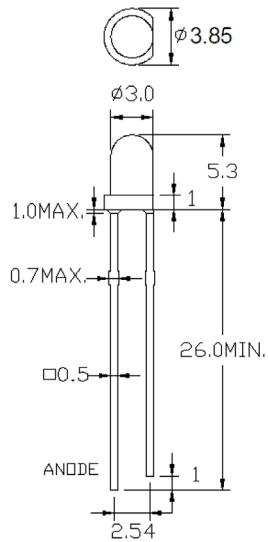

Dimensions : Millimetres  
Tolerance : ±0.25mm

## Part Number Table

Description	Part Number
LED, 3mm, 36°, Super-Red	MCL034RHC

**Important Notice :** This data sheet and its contents (the "Information") belong to the members of the AVNET group of companies (the "Group") or are licensed to it. No licence is granted for the use of it other than for information purposes in connection with the products to which it relates. No licence of any intellectual property rights is granted. The Information is subject to change without notice and replaces all data sheets previously supplied. The Information supplied is believed to be accurate but the Group assumes no responsibility for its accuracy or completeness, any error in or omission from it or for any use made of it. Users of this data sheet should check for themselves the Information and the suitability of the products for their purpose and not make any assumptions based on information included or omitted. Liability for loss or damage resulting from any reliance on the Information or use of it (including liability resulting from negligence or where the Group was aware of the possibility of such loss or damage arising) is excluded. This will not operate to limit or restrict the Group's liability for death or personal injury resulting from its negligence. Multicomp Pro is the registered trademark of Premier Farnell Limited 2019.